



Daisy Quality

We stand by our product.

daisy
pool covers & rollers

Roller

Installation

For All Domestic 5 Star
and UTC Roller Systems



SCAN HERE TO WATCH
OUR FULL HOW TO
INSTALL VIDEO

▶ SCAN ME

AUSTRALIA'S FAVOURITE.

1300 55 18 11 • daisypoolcovers.com.au

Quality | Technology | Service



TOOLS REQUIRED FOR A POOL ROLLER



Electric drill with Phillips head drill bit



Rubber mallet



Adjustable or 13mm spanner



Tape measure



Scissor

INSTRUCTIONS

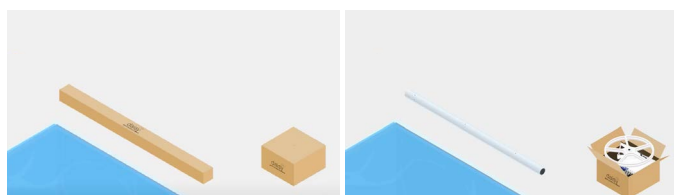

1. After carefully unpacking, start by placing the expandable tube evenly across one end of the pool. (Deep end or roller location).



2. Retract the inner tube until the three holes align with the main tube. (All tubes come with pre-drilled - pre-marked holes. Approx. 300mm wider than pool width).

Notes:

Your tube may be delivered in a number of different styles depending on the model of your roller.

There are two different versions;

1. 5 star fixed length tube (100mm or 75mm)
2. DIY models

If you have a fixed length, pre-manufactured tube, go to step 8.

For all models with a DIY tube continue reading.

The roller tube is best used with a pool cover when it is approximately 300mm wider than the main pool cover area.

Tube diameter for different models

100mm standard

- DIY SMALL 100mm to make roller tubes up to 4.6m long.
- This creates a 2-piece tube with two different style end slugs, one large and one small.
- To help you identify these, 'LARGE' and 'SMALL' are written on the inside of the end slug.



DIY LARGE 100mm to make roller tubes up to 6.4m long

- This creates a 3-piece tube with two of the same LARGE end slugs.

75mm (all UTC are DIY tubes, 5 star can be DIY or fixed length)

- DIY SMALL 75mm to make roller tubes up to 4.6m long.
- This creates a 2-piece tube with two different style end slugs, one large and one small.
- To help you identify, there is 'LARGE' and 'SMALL' written on the inside of the end slug.

50mm Buddy only

- 3 piece 50mm tube with crank handles to go into same size 50mm tube
- Buddy 75 has the insert option to make the 50mm crank fit into the 75mm 2 piece tube

125mm (for longer wider pools) all fixed length pre made



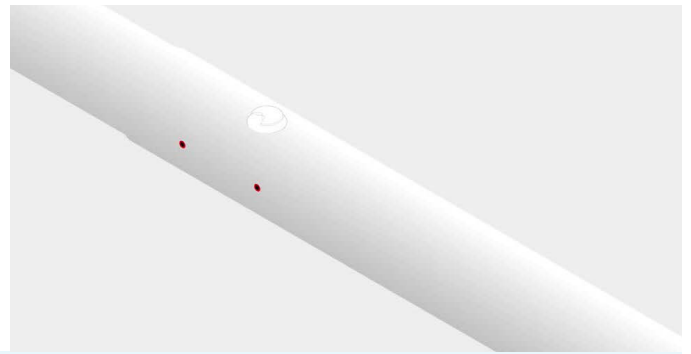
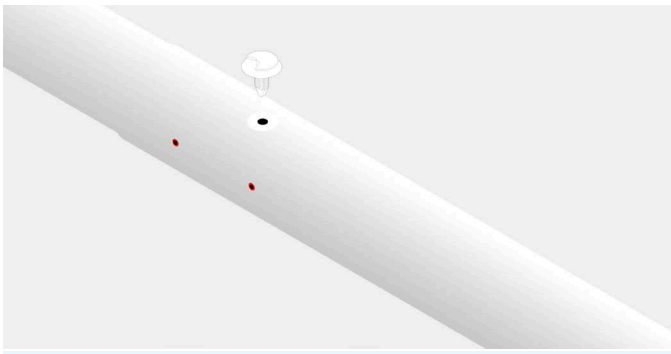

3. Place the white feather plugs into the white marked holes to keep tubes in place prior to drilling self drilling screws. To make a custom size length, use the 6.5mm drill bit supplied to drill new feather plug holes.

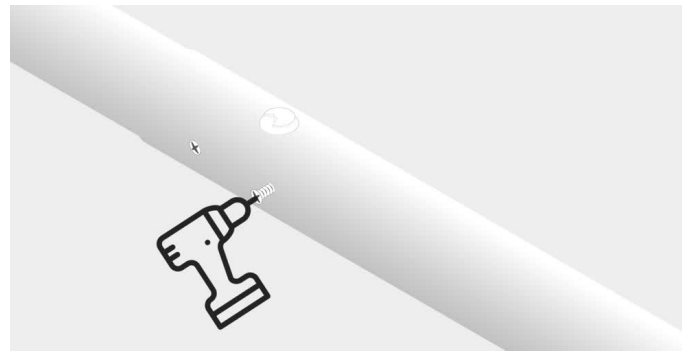
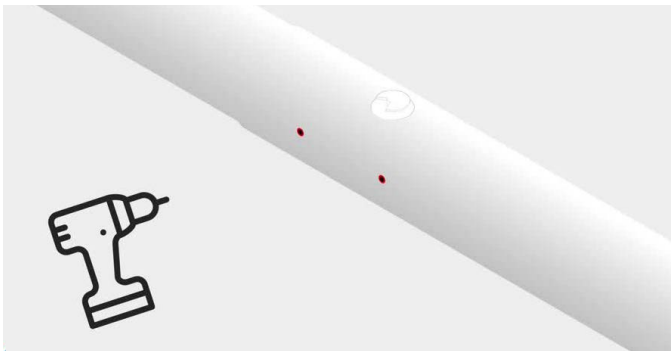

4. Using your drill, begin drilling self drilling screws (6 in total) in the two group of three holes marked red for each join.

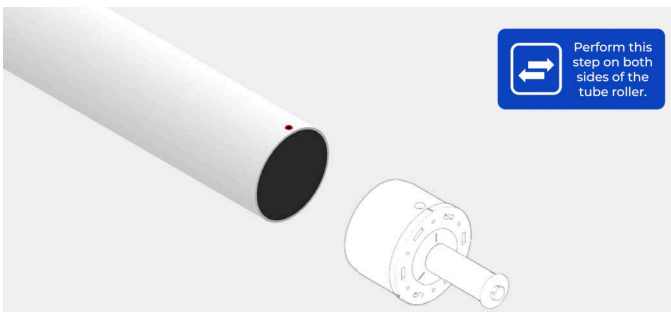

5. Insert end slugs into both ends of the tube. (*Insert larger slug into side of tube that is largest*)

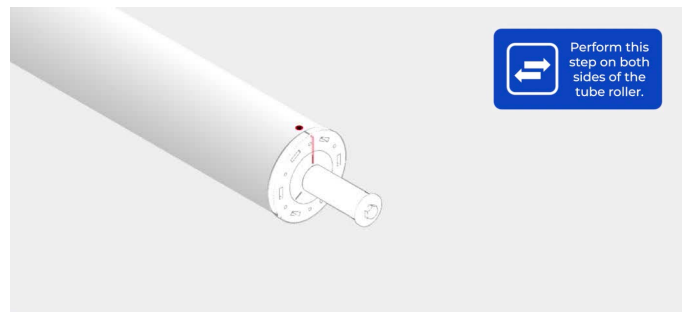

6. Ensure the indicator mark on the end slug is lined up with the red dot hole on tube.

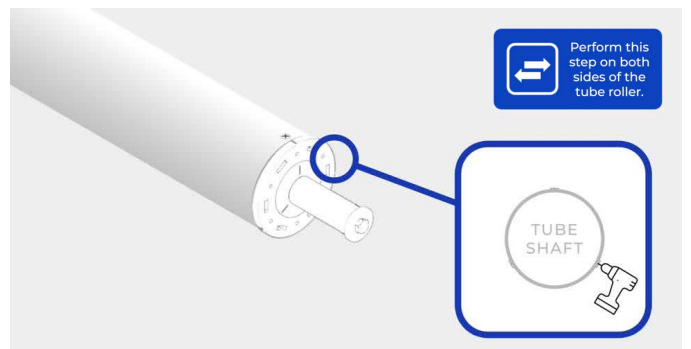
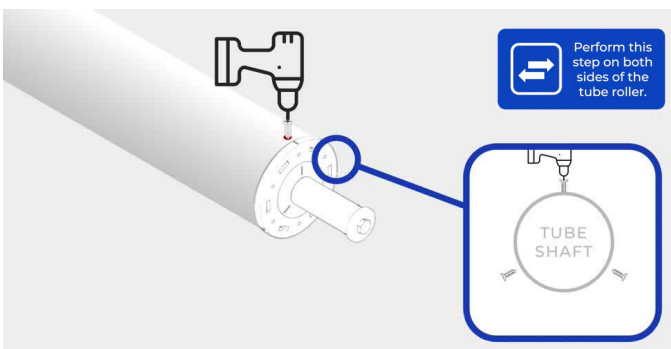

7. Using drill and three self drilling screws on either side (6 in total), secure the end slugs through the red marked holes.



8. Undo retaining bolt and washers using a 13mm spanner

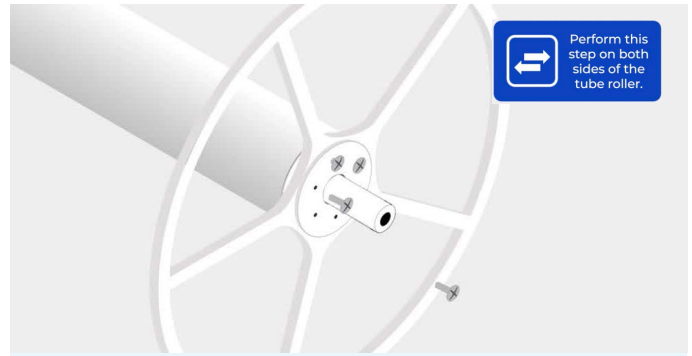

9. Slide the handwheel over the end slug. Align holes, insert stainless steel screws (6) and tighten.

Note: for UTC 4 spoke hand wheels, clip the handwheel into the end slug then secure with the 3 stainless steel screws and tighten.

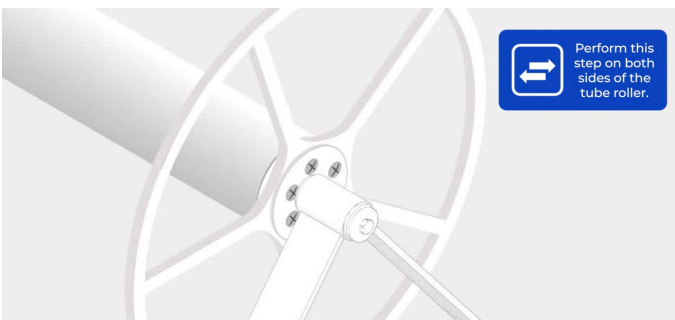

10. Slide frame onto the end slug shaft. Re-install retaining washers and bolts using 13mm spanner.



11. Attaching 'cut to shape' cover to roller.

SCAN HERE TO WATCH OUR FULL HOW TO INSTALL VIDEO

Note: End frames vary from model to model however the method is the same regardless of frames. UTC models: insert the leg into foot before sliding the leg onto the end slug.

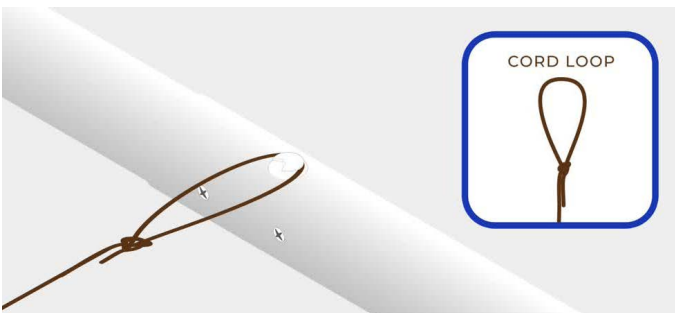

12. Tie loop in one end of the cord, put over white feather plug and gently pull the lock into position.

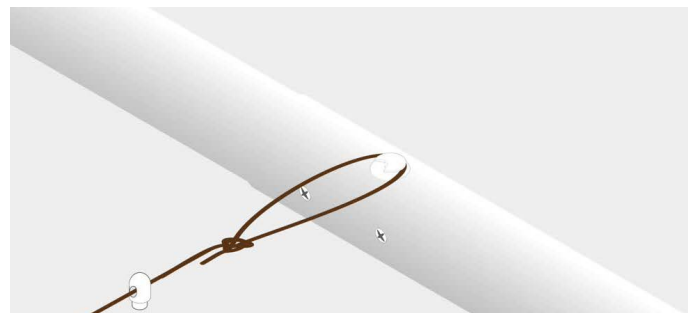

13. Thread cord adjuster onto cord.

Note: The cord adjuster is for 5 Star roller only. The cord adjuster is used in place of tying a knot. If you prefer, you can tie a bowline style knot instead of using cord adjuster. UTC rollers are not supplied with cord adjuster.

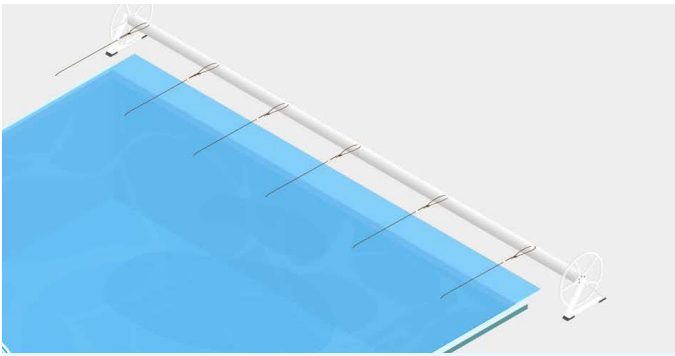

14. Pull pool cover slightly out of pool towards roller so you can install eyelets on the pool cover.

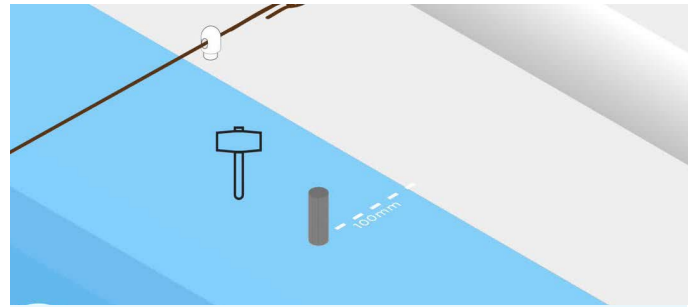

15. In line with the white feather plug and approximately 100mm from the end of the pool cover, punch a hole with the eyelet punch through the pool cover. *(Using a small piece of wood underneath the cover)*

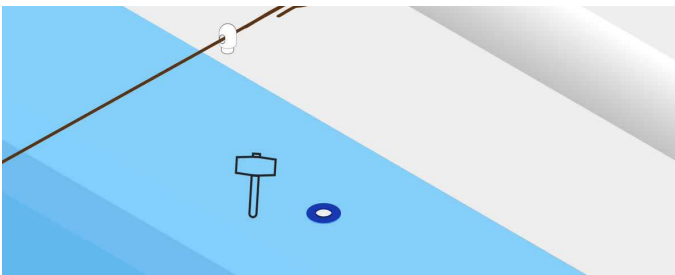

16. Put male section on ground, pool cover hole over male section, then female section of eyelet on top, then strike with rubber mallet to secure the eyelet together.

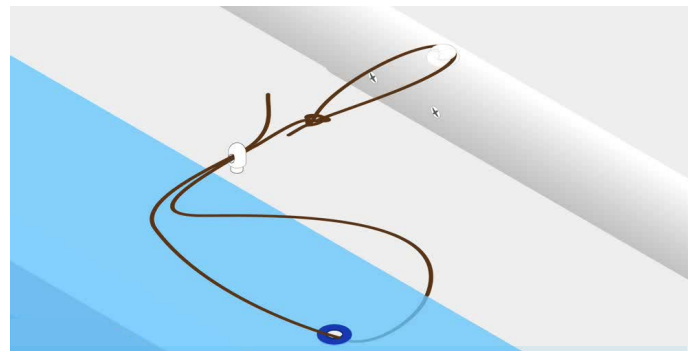

17. Thread cord from underneath cover, through eyelet then back through adjuster.



18. Adjust cords so the pool cover comes onto the roller evenly and square to pool. Minor adjustments may be needed from time to time to fine tune the settings for smooth cover recovery.

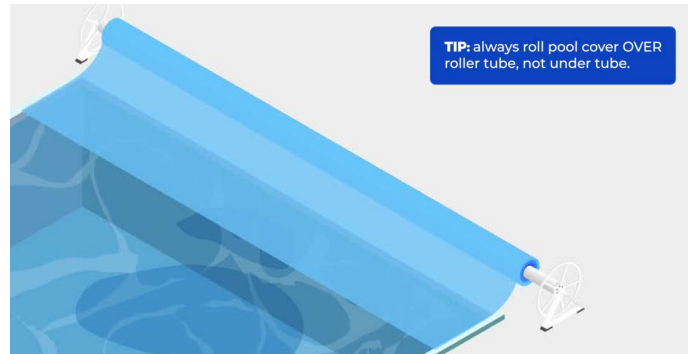

TIP: always roll pool cover OVER roller tube, not under tube.

19. Roll the cover up by rotating the handwheels.

Note: The over cover must be used to protect a rolled up pool cover when it is stored off the water



20. Lay out white over cover sheet, cut size to roller tube length. (inside hand wheel length). DIY & UTC over covers need to be made to suit roller tube lengths. 5-star, pre-manufactured tubes come with pre made over covers.



HOW TO MAKE OVER COVER TO SUIT ROLLER

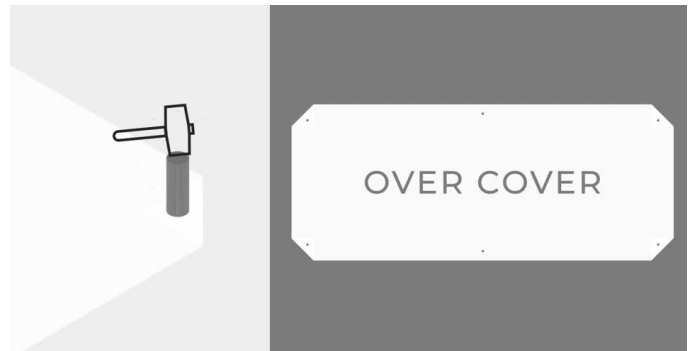
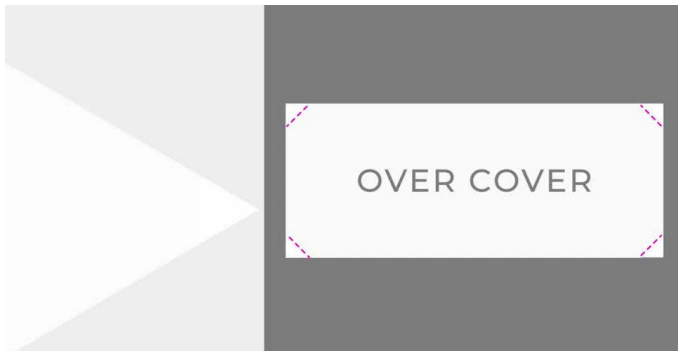

1. Fold each corner over approx 30mm in, then punch hole in each corner and in center approx 50mm in from edge.

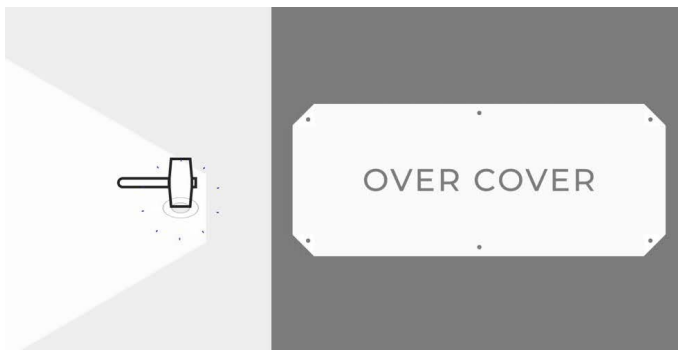

2. Install white eyelets through each hole.

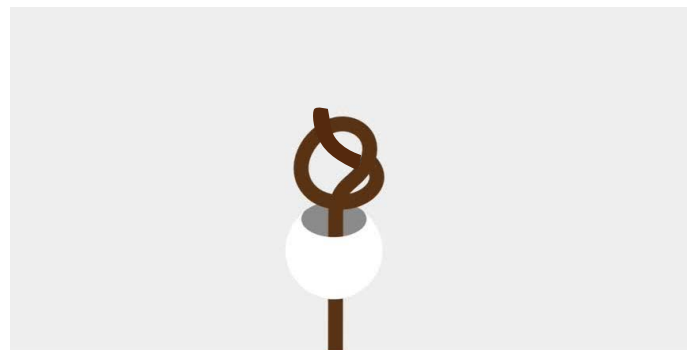

3. Get 2 shock cords, tie knot in one end. Then thread on white ball to stop going through eyelet.

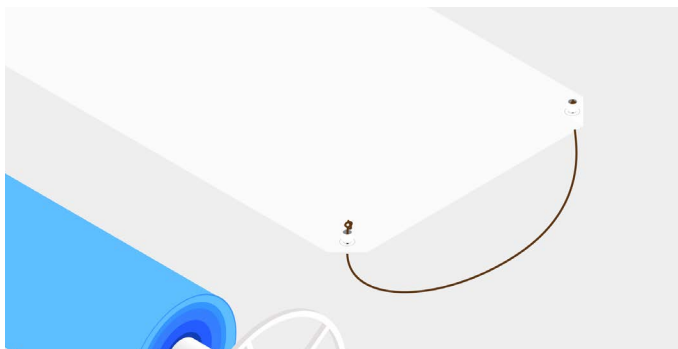

4. Thread from underside, out eyelet then back through other eyelet, put on another white ball and tie knot to secure.

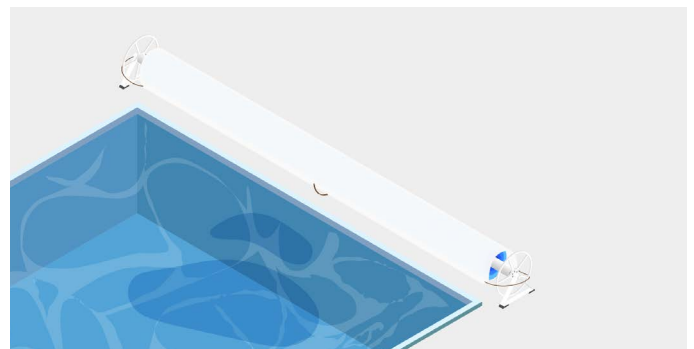

Always use the over cover when your pool cover is on the roller, even if it is for a 5 minute swim

HOW TO INSTALL POOL COVER

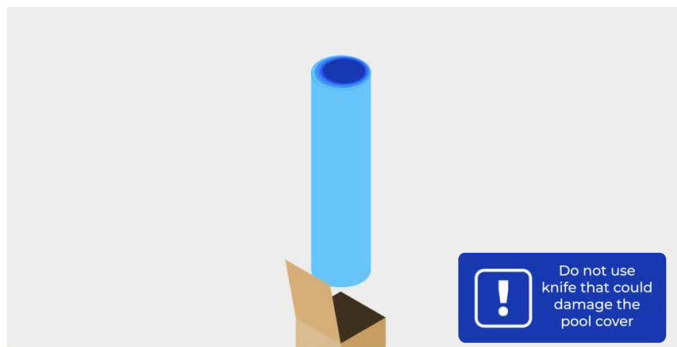

1. Open box and pull cover out, ensuring it remains rolled up

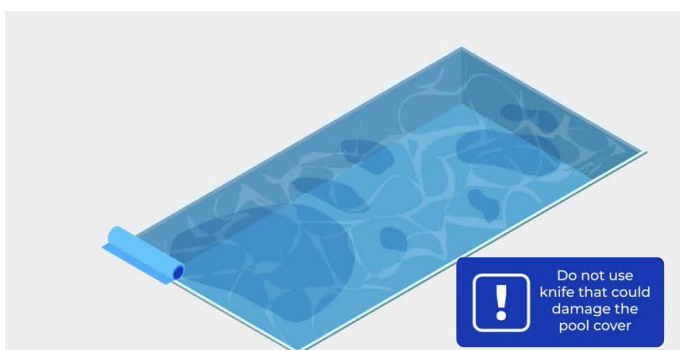

2. Lay the rolled up cover at one end of the pool and remove tape

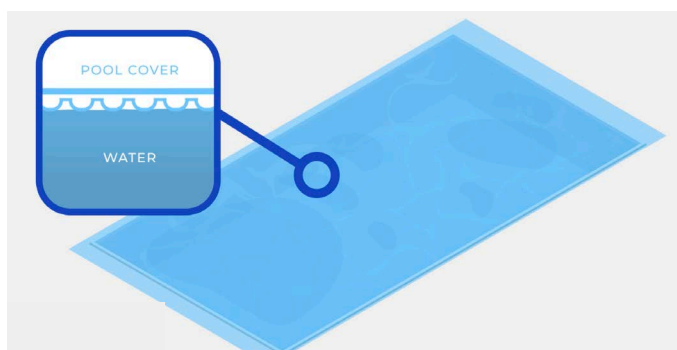

3. Ensuring bubbles are facing down, roll out cover and fold out to ensure the pool is covered and no air bubbles or pockets are visible

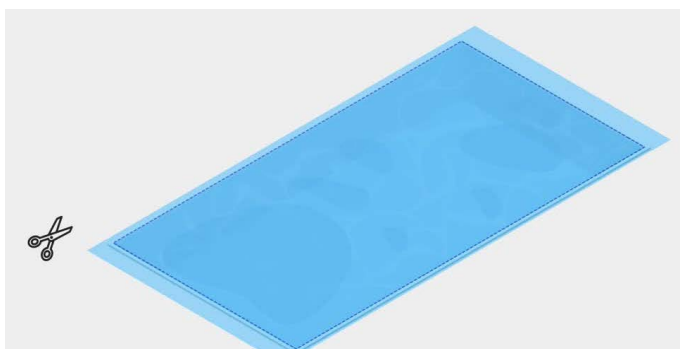

4. Grab a pair of sharp household scissors. Use the pool as a template while someone holds the pool cover in place

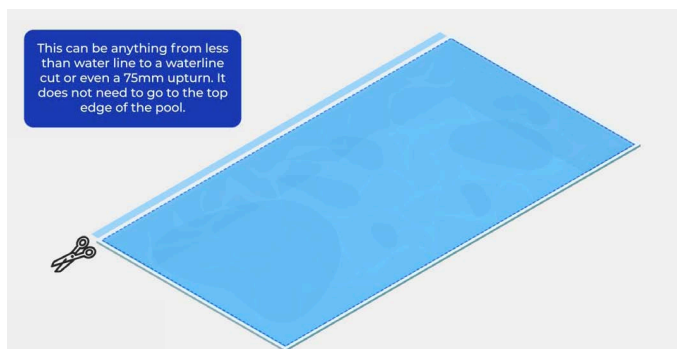

5. Cut the edge of the cover so it fits the pool as you like

PROOF OF PURCHASE

Your Daisy products come fully warranted. For your personal records, fill in the details below or register online at daisypoolcovers.com.au/register-warranty/

Date purchased: _____

Purchased from: _____

THE ORIGINAL
Daisy

Daisy Quality

We stand by our product.

daisy
pool covers & rollers

CARE TIPS

1. Whenever the cover is rolled up on the roller, ensure the over-cover is in place.
2. Use the white over-cover EVERY TIME you store your pool cover on the roller. Even if the swim is only for 10 minutes, the over-cover must be in place as this is enough time to damage a pool cover.
3. Roll your cover over the top of your roller. Locate the roller at the opposite end of any extended areas (ie; steps/ swim outs) and fold over to roll up. (See below)
4. When recovering your pool cover onto the roller ensure it rolls up evenly! Also ensure the over-cover is used every time.
5. Fold in any swimouts or step areas on the cover before rolling it up. This will ensure that you don't put excessive force on the cover and allow it to move easily.
6. When deploying the cover back onto the pool, roll the cover out slightly, fold one corner over onto itself to create a bow effect, then pick up the other corner and walk slowly down the side of your pool.
7. To prevent damage to your cover, do not drag the cover over abrasive pool decking or any sharp surfaces.
8. Excessive temperatures can damage your cover. Ensure your pool does not reach excessive temperatures.
9. Most dirt and debris can be hosed or swept into your skimmer box. If you have a large amount of debris on top of your cover, a broom or brush can be used to sweep it into a pile for removal. Water and a soft brush are all that is required to remove heavier grime.
10. If a storm is imminent, roll up the cover and store it safely.
11. Do not sit or step on your roller. If the tube gets bent, it cannot be repaired
12. When using your roller, ensure that the brakes on the castors are locked.

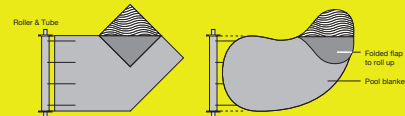

SCAN HERE TO WATCH
OUR FULL HOW TO
INSTALL VIDEO

▶ SCAN ME

AUSTRALIA'S FAVOURITE.

1300 55 18 11 • daisypoolcovers.com.au

Quality | Technology | Service

